



Crime Prevention Products



Advance Pepper Spray

Advanced Pepper spray an ideal personal safety tool for working women, college girls, businessmen, security guards, travelers etc. Its a perfect match to world-class pepper sprays standards in terms of quality and design.



- Spray Range is upto **7-10 ft** : Helps in protecting from a safe distance
- Enough pepper content to make **20-23 shots**.
- Highly Strong formula with **10% O.C content**.

- **Flip-flop safety cap** [imported] for easy use and preventing child misuse.
- **360-degree valve** to shot pepper spray from any angle.



Kitty-Knuckle

Kitty-Knuckle will make you more effective in your self defense. The kitty's two sharp ears can be really painful when hit with force to attacker. The eye hole are made to have a firm grip by inserting two of your fingers.



- Compact, tough, easy to use. Features a detailed snarling kitty cat design.
- Eye-holes for fingers are about a 13 ring size.

- This model is especially compact allowing you to use your fist or an open hand as you choose without losing it.
- Very convenient, easily fits into pocket or purse.



Expandable Baton

Batons are used worldwide for self defense that delivers strong striking power to keep the criminals aside. These retractable batons are great for police enforcement, security guards, and effective for personal self-defense giving you that extra reach and advantage!



- 24 cm telescopic solid iron expandable baton [collapsed mode]
- 26 inches solid iron rod when extended with jerk.
- Foam padded grip for a firm and anti-slip holding.

- Great protection against aggressors, rapists and vicious dogs..
- Made of extra hard titanium steel hardened materials with exquisite workmanship.
- Easy to use, just a flick of your wrist. Comes with a carrying box and a pouch.
- No-flake or peel and anti-rust.





Drache

**STUN GUN CUM
BATON CUM
FLASHLIGHT**

3 MILLION VOLTS



- Network and car charging
- Removable, replaceable rechargeable battery
- Metal attachment carabiner
- Quick-release button



- Anti slip handle
- Possibility to disassemble for convenient transportation
- 3 flashlight modes
- Light power: 300 lumens



ELECTRA

STUNGUN CUM FLASHLIGHT

3.8 MILLION VOLTS



- Generates a powerful but non-lethal electric shock of 3.8 million volts.
- Flashlight to blind the person on gaze.
- The paralyzing effect is instant.
- Disable the attacker for up to 5 minutes, buying you the time to escape.



- Safety lock to avoid child misuse.
- Rechargeable up to 1000 times.
- With a strong flashlight of 210 Lumens, it can focus up to 200 meters that helps you to locate and navigate at night.



E- WAVE

COMPACT AND POWERFUL

9 MILLION VOLTS



- A Compact Stun Gun
- Light weight & compact
- Inbuilt torch facility
- Includes charger
- Over 5000 kv output power
- Includes safety pouch
- Strong led illumination



- Source voltage: 6 V.
- Output pulse voltage: 900 KV.
- Environment temperature: 5 to 113 degree Fahrenheit.
- Includes Charger, safety pouch.
- Strong LED flashlight.

ELECTRON PLUS

Heavy-Duty stun gun

6.8 Million Volts ⚡



- Big Capability AC discharge circuit, high Voltage, good personal protection equipment.
- Super LED flashlight save energy more durable.
- Re-Chargeable.
- Aircraft-grade aluminum, HA III anodic oxidation.



- Use enclosed charger input 220-240V power
- Run time: 4 Hour
- LUX: 500 Lumens (Max output)
- Power input DC 4.8V
- Current: >2.5A
- Size: 23.6 x 4.8 x 2.9 (mm)
- Power output: 6800kV



BLING

LADIES SPECIAL

3.8 MILLION VOLTS



- This Self Protection Device comes equipped with a flash torch and stun gun.
- The effect in instant.
- Compact design : Easy to carry in bags.
- Shiny design for non identification as a Self-defense tool.
- Rechargeable device.



- Full charged stun gun can generate electric shock upto 50 times.
- Standby battery backup : 30 days.
- Flashlight helps you to locate and navigate at night.
- Power output:3.8 million volts

BASU E-ALARM PERSONAL SAFETY



Loud: 120 db. Alarm
TSA approved – Safe carry
on flights
Long lifespan: 30 minutes
total alarm use – Battery Life
5 years
Multiple use: Reinsert pin
and use again

IGT GAS SAFETY DEVICE-M02



- Gas Safety Devices helps you in protecting your household by stopping or preventing the gas leaks and accidents caused. These devices are produced using modern and sophisticated technologies that make them perfect.
- Reduces the LPG consumption rate.
- If Gas Pipe is cut or damaged, then it stops mechanically
- Warranty:- 5 Years Warranty Period. IGT will replace the entire damaged regulator free of cost.
- It has Major Leak Auto Shut Off Facility.
- Warranty Card and Insurance Card is inside in the Box.

STRATA



GPS+AGPS+LBS positioning Allow the location to be pinpointed accurately and rapidly

Vibration and movement alert Acquire instant alert when vehicle is vibrated or moved unexpectedly

Geo-fence alarm Create geofences in circle or rectangle for key locations Low battery & Shutdown notice Receive notice when the device needs for charging

SOS call & Speed-dial Thumb sized button allowing urgent call during an emergency case

Two-way communication With MIC and speaker. it`s easy to realize voice-monitor or two-way audio

Intelligent power management Reduce inefficient power consumption when the device stays idle

IP65 dust and waterproof Water-resistant to ensure stable operation in a tough environment

GPS CHILD WATCH- Q50



It features real-time tracking of your kid that is accurate to seconds. The kids watches can exhale 3 numbers and uses GPS and base station aided positioning support to continuously track the position of your kid.

□ Multifunction Kids Smart Watch Support Micro SIM Card (Not provided, need separately), Two-way calls, SOS emergency call, GPS Tracker, Security fence, Fitness Tracker, Pedometer, Voice Chat on App, Alarm Warning of taken off.

□ GPS +LBS (Base station positioning) Dual mode positioning means double safety for kids.

Material Environmentally friendly material with lower radiation compared with competitor product, and will protect your kid's eyesight, waterproof for washing hand and playing games casually

Two-way voice calling: add up 10 mobile numbers on the app to which watch can call. Do not disturb time interval can be set from the app to avoid disturbance when child is in school

Sos button: child can make sos call through one button. The watch will automatically call and send an SOS text message

Voice message: parents can send voice messages to the watch, kids can listen recorded voice message with press of a button. Kids can send voice messages to their parents who can listen these recorded messages on app

XBOOM TRACKER V1.0 (WE TRACK LITE)



- Perfect for car rental, fleet management, and logistics, the best-in-class GPS device WeTrack Lite is compact and lightweight, which only weights 26.6g. Featuring improved accuracy, it is designed specifically to make locating and routing vehicles as simple as possible. Hidden LED makes the device “invisible” and drivers will never know it’s there unless you tell them. GPS+LBS positioning: Allow the location to be pinpointed in real time or periodically
- Hidden LED: Whoever use your car will never know he or she’s being tracked
- IPX5 waterproof: Water-resistant to ensure stable operation in a tough environment
- Multiple alarms: Instant alerts for over speed, low battery, vibration, etc
- Compact size: Be able to place it in various locations throughout the vehicle
- ACC detection: Be aware of the ignition status whenever you need
- FREE 1 YEAR SOFTWARE SUBSCRIPTION

JC100- CAM GPS TRACKERS



- 3G + WIFI Surfing network anytime anywhere.
- Live surveillance Wide Dynamic Range technology to capture the best light exposure,
- giving you flawless night-time recording and detail capture.
- Cloud Server Protect your data and privacy. Make your video backup safer.
- 1080P video recording 1920 x 1080 Full HD resolution at 30 fps with
- H.264 compression technology for more storage.
- Built-in dual cameras Ultra-wide 150-degree viewing angle captures more of the road around you.
- With G-Sensor, the device can lock data to memory, which is helpful in insurance claims.
- Night Vision Inward camera provides white-black color night vision.
- Android 5.1 system it runs more quickly, smoothly and stable.
- Vibration alarm is turned on after the vehicle stops the engine for 5 minutes. Alarm message will be pushed to APP if any vibration detected.

JC 200 – CAM GPS TRACKER

The JC200 is a 3G video-based telematics camera with a difference, providing cutting-edge technology and the following features: Live surveillance: Wide Dynamic Range technology to capture the best light exposure, giving you flawless night-time recording and detail capture.

Cloud Server: Protect your data and privacy. Make your video backup safer.

1080P video recording: 1920 x 1080 Full HD resolution at 30 fps with H.264 compression technology for more storage.

Built-in dual cameras: Ultra-wide 145-degree viewing angle captures more of the road around you. With G-Sensor, the device can lock data to memory, which is helpful in insurance claims.

Android system: With Android 5.1 smart systems, it runs more quickly, smoothly and stable, which allows customers to do second development freely.

Vibration alarm is turned on after the vehicle stops the engine for 5 minutes. Alarm message will be pushed to APP if any vibration detected.

Driver's Behavior Analysis: The built-in 9-axis G-sensor enable the camera to perform better for driver's behavior analysis. Bad behaviors like harsh acceleration, hard braking, the sharp turn will be pre-warned and secured. All events data will be saved locally in TF card as well as the cloud server



AT4- WIRELESS ASSET TRACKER



- The advanced features, rugged construction and industry-leading battery life make the AT4 the new state of the art in GPS vehicle tracking. Using GPS, LBS positioning, AT4 gives detailed reports and tell you exactly where a vehicle has been, where it's headed and how fast it's traveling. With 10000mAh battery and IPX5 water proof to maximize performance, it puts you in total control of individual vehicles or fleets. Strong magnet facilitates the installation while built-in MIC realize voice monitoring.
- GPS+LBS positioning Allow the location to be pinpointed in real time or periodically
- Listen-in Listen to the surroundings by sending a text message
- IPX5 water proof Water-resistant case to ensure stable operation in tough environment
- 10000mAh battery High capacity Li-ion battery ensuring sufficient power supply
- Intelligent power management Reduce inefficient power consumption when the device stays idle
- Strong magnet Strong magnetic cover allowing for flexible mounting on vehicles or assets
- Tamper alert Once the device is disassembled, you will get informed immediately
- Tracked by: SMS, APP, Web Reports location in real time through different interfaces

QBIT MICRO GPS TRACKER



- Micro GPS Tracker is a portable wireless GPS tracker useful for tracking and monitoring anything. It Could be very helpful in sending the help signal and location details in case of emergency. It can also be used for spy purpose or for simple communication.
- Live location tracking on Google map
- SOS emergency button to trigger immediate call to three contacts.
- Silent Audio surveillance : Automatically connects incoming call after 3 rings.
- Two-way calling from any corner of the world.
- Senses sudden vibration and send call alert (in case of glass break or person falling)
- Geofence, automatic alarm when out of range
- Historical route of three months on location, trip etc.,
- IPX5 Waterproof device.
- Beautiful LED lighting for easy identification in dark.

INTEX GPS WATCH

- Geo-Fencing + Supports GPS/LPS/Wi-Fi
- Maintains Tracking History
- Auto-call
- Forbidden in Class
- Shows Current Location
- High On Safety – SOS
- Voice Chat
- Two-way Calling
- Block Unknown Number
- Power Saving Mode
- Add Alarm
- Make Friends
- Care Time



ID CARD GPS TRACKER

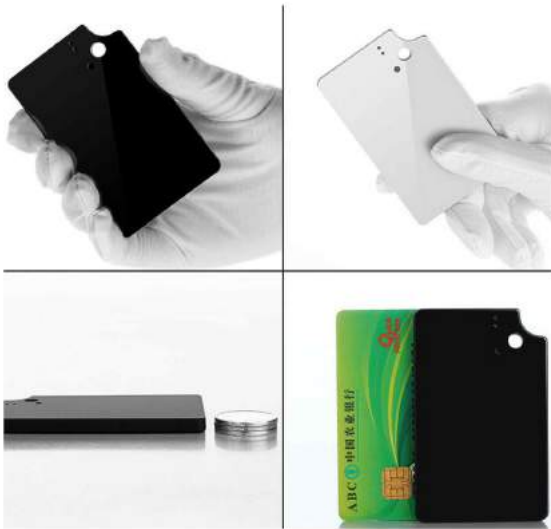

- HANG it anywhere, TRACK it anywhere!
- Get the sleekest and stylish GPS tracking device which can be used to track the live location of Children, Luggage, Keys and other personal valuables within the ease of your fingertips as this device also provides the best protection against theft and burglary!
-
- SOS alarm
- Tracking by SMS/WEB/APP/WECHAT
- Google map link
- Real-time tracking
- Historical tracks query
- Mileage Statistics
- Group management
- Geo-fence
- Voice surveillance
- Vibration alarm
- Over-speed alarm
- Low power alarm

ALARM LOCK



- Strong built Anti-theft alarm lock to protect your home, bikes, and luggage. It is a multi-purpose lock that can sound a loud siren (130db). This device is built strong and can be easily carried.
- This high-security design is rainproof, rust proof & weatherproof. It is ideal for garden sheds and houses, garages, caravans, bicycles, gates etc.
- The lock has a built-in security system that activates the alarm if anyone tries to put something foreign into the lock for example – a wrong key.
- Corrosion Resistant with hardened Zinc Alloy Body
- The alarm resets automatically

DOOR ANTI-THEFT SYSTEM (GSM)



- This Home Security System is an essential device to protect your home and valuable from burglary. It has two functionalities, firstly loud siren, secondly phone call alert. Its a must have product in this era of security.
- Instant Loud Siren of 110 db.
- Call alert in case of intrusion detection.
- Battery operated (Lasts upto 1 year): No Electricity required.
- Easy to operate.
- One year Guarantee
- Special facility of extensions for back Doors Windows.
- Suitable for –Bungalows, Flats, Godown, Banks, Jewelers, Post offices, Apartment, Duplex, Farmhouse, Godowns and warehouses.

WIRELESS WIFI IP CAMERA



- Motion detection and intelligent alerts can send real-time push notifications to your phone with captured images while you're away. This helps you keep surveillance of your premises all the time and also monitor/notify using your handheld smart devices.
- HD Quality Video recording.
- Live Video transmission on Mobile Application.
- Motion Sensor: Detects any unwanted intrusion and sends an instant alert.
- IR Night Vision: HD night vision with inbuilt IR lens for crisp and clear images even in dark.
- 360 Degree Mobile Control: Rotate camera horizontally or vertically from anywhere in the world using mobile application
- Enhanced Two-Way Communication
- Very Easy to set up and operate
- Supports up to 64 GB memory card.

SHUTTER SECURITY SYSTEM (GSM)



- Shutter Security System(GSM) is an innovative safety product in this security era. It comes with dual functionalities, which gets activated in case of unauthorized entry through the shutter. First, it gives you the alert via phone call. Second, it instantly raises loud siren. It is a tailor made safety device designed for the total protection of shops, godowns, and offices from burglary.
- Instant Loud Siren of 110 db.
- Call alert in case of intrusion detection.
- Battery operated : No Electricity required
- Easy to operate. One year Guarantee.
- Special facility of extensions to multiple shutters(On special orders).
- Suitable for –Shops, Banks, Post offices, Apartment, Duplex, Farmhouse, Godowns and warehouses.

CTAG – BLUETOOTH TRACKER



- cTag is an innovative multi purpose device to keep track of your valuables, capture your moments, voice and much more. It is a bluetooth 4.0 low energy products which works through cTracing app.
- Easily find the tagged objects like wallet, kid, pets, bags, cars or other belongings
- Find phone function – Two-way anti lost i.e. phone to cTag or cTag to phone
- Remote Shutter for selfie.
- Voice recording function
- Locate your car in the parking lot on map.
- Effective Range: <25 m (outdoor environment)

ABOUT US

XBOOM is an endeavour established to make a remarkable improvement in the safety scenario of the society.

Our team strives with endless passion & dedication to provide innovative safety products which help in ensuring safety independently.

Clients We Served



BE FEARLESS

EQUIP YOURSELF



**JOIN US
TODAY**

Website : www.xboom.in

Call : 080-26662616, +91-7795067437

Xboom Utilities Pvt Ltd

Head Office : #212, 6th cross,
2nd main, JHBCS Layout,
Bangalore - 560078